

Public Document Pack

Blackpool Council

11 July 2017

To: Councillors G Coleman, Hunter and D Scott

The above members are requested to attend the:

LICENSING PANEL

Thursday, 20 July 2017 at 2.00 pm
in Committee Room A, Town Hall, Blackpool

A G E N D A

1 APPOINTMENT OF CHAIRMAN

To appoint a Chairman for the meeting.

2 DECLARATION OF INTEREST - LICENSING

Members are asked to declare any interests in the items under consideration and in doing so state:-

(1) the type of interest concerned

(2) the nature of the interest concerned; and

(3) whether they have or have not sat on a Planning Committee which has previously considered a planning application in respect of a licensed premises which is also subject to consideration for a premises licence as part of the agenda for this meeting.

If any Member requires advice on declarations of interests, they are advised to contact the Head of Democratic Governance in advance of the meeting.

(Members are asked to also pay particular attention to the guidance sheet on interests supplied with the agenda).

3 PROCEDURE FOR THE MEETING

The Chairman of the Panel will summarise the procedure and announce the equal maximum amount of time for each party to speak for the hearing.

- A. Items 1 and 4 (b) will be undertaken in private session by the Panel and not in the Meeting Room.
- B. Items 2, 3, 4(a) and 4(c) will be recommended to the Panel to be held in public.
- C. The Panel may decide to exclude the public from all or part of a hearing where it considers that the public interest in so doing outweighs the public interest in the hearing, or that part of the hearing, taking place in public. (This includes a party and any person assisting or representing a party)

4 APPLICATION FOR A PREMISES LICENCE- FOLKLORE

(Pages 1 - 34)

- . APPLICATION AND REPRESENTATIONS SUBMITTED. To consider the attached report
- b. DETERMINATION OF THE APPLICATION FOR A PREMISES LICENCE- Folklore
- c. ANNOUNCEMENT OF THE DECISION FOR A PREMISES LICENCE- Folklore

Venue information:

First floor meeting room (lift available), accessible toilets (ground floor), no-smoking building.

Other information:

For queries regarding this agenda please contact Lennox Beattie, Executive and Regulatory Manager, Tel: 01253 477157, e-mail lennox.beattie@blackpool.gov.uk

Copies of agendas and minutes of Council and committee meetings are available on the Council's website at www.blackpool.gov.uk.

| | |
|--------------------------|---|
| Report to: | Licensing Panel |
| Relevant Officer: | Sharon Davies, Head of Licensing Services |
| Date of Meeting : | 20 July 2017 |

APPLICATION FOR A PREMISES LICENCE – Folklore

1.0 Purpose of the report:

1.1 To consider an application for a Premises Licence in respect of Folklore, 13 Westcliffe Drive.

2.0 Recommendation(s):

2.1 The panel are requested to consider the application and determine whether the granting of this licence would adversely impact on the licensing objectives.

3.0 Reasons for recommendation(s):

3.1 Representations have been received therefore there must be a hearing to determine the application.

3.2a Is the recommendation contrary to a plan or strategy adopted or approved by the Council? No

3.2b Is the recommendation in accordance with the Council's approved budget? Yes

3.3 Other alternative options to be considered:

None, once an application has been submitted and representations received it must be considered by the Licensing Panel.

4.0 **Background Information**

4.1 On 31 May 2017, the Licensing Service received an application from Janusz Artur Kuca for the grant of a Premises Licence at Folklore, 13 Westcliffe Drive.

4.2 The application requests permission for the sale of alcohol for consumption off the premises 08.00 – 20.00 hours daily. A copy of the application is attached at Appendix 4a.

4.3 Representations have been received from members of the public. Copies of the representations are attached.

4.4 **Local policy considerations**
None

4.5 **National policy considerations**

9.42 – The authority’s decision should be evidence-based, justified as being appropriate for the promotion of the licensing objectives and proportionate to what it is intended to achieve.

9.43 – Determination of whether an action or step is appropriate for the promotion of the licensing objectives requires an assessment of what action or step would be suitable to achieve that end. Whilst this does not therefore require a licensing authority to decide that no lesser step will achieve the aim, the authority should aim to consider the potential burden that the condition would impose on the premises licence holder as well as the potential benefit in terms of promotion of the licensing objectives. However, it is imperative that the authority ensures that the factors which form the basis of its determination are limited to consideration of the promotion of the licensing objectives and nothing outside those parameters.

4.6 **Observations**

The police have agreed a number of conditions with the applicant which will be added to the licence if granted:

1. The Licence holder is to support and rigorously enforce the Challenge 25 proof of age policy.

Any person who looks or appears to be under the age of 25 shall be asked to provide identification that they are over the age of 18. The following are the only forms of identification acceptable:

- i. UK photo driving licence
- ii. Passport
- iii. Proof of Age Standards Scheme Card
- iiii. Armed Forces ID card

Signs promoting this policy will be prominently displayed at public entrances and alcohol sales areas

2. All staff to have received suitable training in relation to the proof of age scheme to be applied upon the premises. Records to evidence this will be made available to an authorised officer upon request. Refresher training shall be conducted every 4 months as a minimum.
3. CCTV will be installed internally and externally at the premises and will comply with the following:
The CCTV system shall be installed, maintained and operated to the reasonable satisfaction of Lancashire Constabulary. All public areas of the premises are to be covered by the system. The system will incorporate a camera covering each of the entrance doors and will be capable of providing an image which is regarded as identification standard.
The system will display on any recording the correct time and date of the recording.
The system will make recordings during all hours the premises are open to the public.
Digital recordings shall be held for a minimum of 21 days after the recording is made and will be made available to the Police or any authorised persons acting for a Responsible Authority for inspection upon request.
The system will, as a minimum, record images of the head and shoulders of all persons entering the premises.
4. A staff member who is conversant with the operation of the CCTV system will be on the premises at all times the premises are open to the public. This staff member will be able to show recent data or footage with the absolute minimum of delay when requested to a Police Officer or to a Local Authority Enforcement Officer.
5. The Licence Holder or Designated Premises Supervisor shall notify the Police Licensing Unit on any occasion when the CCTV is to be inoperative for a period in excess of one working day and shall provide a certificate from a competent person stating the reason for the system being inoperative and the measures which have been taken to satisfy the licence conditions.
6. Appropriate signage alerting customers to CCTV recording shall be displayed in conspicuous positions on the premises.

7. An authorisation of sales, signed and dated by the DPS, shall be kept at the premises showing all persons authorised by them to make sales of alcohol at the premises.
8. No alcohol with an ABV above 5.5% shall be sold in single cans, with the exception of occasional items that are sold because their original packaging has been damaged.
9. No beer or cider may be sold with an ABV above 7%.
10. A Personal Licence holder will be available to attend the premises within 30 minutes while the sale and supply of alcohol takes place.
11. A refusals register to be kept and maintained which is readily available for inspection by a Police Constable or authorised officer and this register will be reviewed weekly by the licence holder or Designated Premises Supervisor.

4.7 Does the information submitted include any exempt information? No

4.8 **List of Appendices:**

Appendix 4a: Application
 Appendix 4b: Representations from members of the public

5.0 **Legal considerations:**

5.1 Please see local and national policy in the background information.

6.0 **Human Resources considerations:**

6.1 None.

7.0 **Equalities considerations:**

7.1 None.

8.0 Financial considerations:

8.1 None.

This page is intentionally left blank

Blackpool Council

APPLICATION FOR A NEW PREMISES LICENCE

Applicant Name(s):

JANUSZ ARTUR KUCA

Contact

Licensing Service
Blackpool Council
Municipal Buildings, PO Box 4
Blackpool, FY1 1NA

T: (01253) 47 8572 / 8589
F: (01253) 47 8372

www.blackpool.gov.uk/licensing



Application for a premises licence to be granted under the Licensing Act 2003

PLEASE READ THE FOLLOWING INSTRUCTIONS FIRST

Before completing this form please read the guidance notes at the end of the form.
 If you are completing this form by hand please write legibly in block capitals. In all cases ensure that your answers are inside the boxes and written in black ink. You may wish to keep a copy of the completed form for your records.

I/We JANUSZ ARTUR KUCA

[insert name of applicant/s]

apply for a premises licence under section 17 of the Licensing Act 2003 for the premises described under Part 1 below and I/we are making this application to you as the relevant licensing authority in accordance with section 12 of the Licensing Act 2003.

Part 1 – Premises Details

| | | | | | | | | |
|--|---|-----------|---|---|---|---|---|---|
| Postal address of premises or club premises if any, or if none the Ordnance Survey map reference or description. | | | | | | | | |
| Premises Name | FOLKLORE | | | | | | | |
| Premises Address | 13 WEST CLIFFE DRIVE | | | | | | | |
| | BLACKPOOL | | | | | | | |
| | <table style="width: 100%; border-collapse: collapse;"> <tr> <td style="width: 15%; border: 1px solid black;">Post Code</td> <td style="border: 1px solid black;">F</td> <td style="border: 1px solid black;">Y</td> <td style="border: 1px solid black;">3</td> <td style="border: 1px solid black;"> </td> <td style="border: 1px solid black;">7</td> <td style="border: 1px solid black;">B</td> <td style="border: 1px solid black;">J</td> </tr> </table> | Post Code | F | Y | 3 | | 7 | B |
| Post Code | F | Y | 3 | | 7 | B | J | |
| Telephone Number of premises (if any) | 01253 522077 | | | | | | | |
| E-Mail Address | OFFICE@folklorestore.uk | | | | | | | |

| | |
|--|--------|
| Non-Domestic Rateable Value of Premises | £ 7300 |
|--|--------|

~~31/5/17~~

Part 2 – Applicant details

Please state whether you are applying for a premises licence as:

Please tick:

- | | | |
|---|-------------------------------------|--------------------|
| a) An individual or individuals * | <input checked="" type="checkbox"/> | Complete Section A |
| b) A person other than an individual* | | |
| I. As a limited company / limited liability partnership | <input type="checkbox"/> | Complete Section B |
| II. As a partnership (other than limited liability) | <input type="checkbox"/> | Complete Section B |
| III. As an unincorporated association, or | <input type="checkbox"/> | Complete Section B |
| IV. Other (for example a statutory corporation) | <input type="checkbox"/> | Complete Section B |
| c) A recognised Club | <input type="checkbox"/> | Complete Section B |
| d) A charity | <input type="checkbox"/> | Complete Section B |

- e) The proprietor of an educational establishment Complete Section B
- f) Health Service Body Complete Section B
- g) A person who is registered under Part 2 of the Care Standards Act 2000 (c14) in respect of an independent hospital in Wales Complete Section B
- ga) A person who is registered under Chapter 2 of Part 1 of the Health and Social Care Act 2008 (within the meaning of that Part) in an independent hospital in England. Complete Section B
- h) The Chief Officer of Police of a police force in England and Wales Complete Section B

***If you are applying as a person described in (a) or (b) please confirm by ticking yes to one of the boxes below:**

- If yes please tick
- I am carrying on or propose to carry on business that involves the use of the premises for licensable activities; or
- I am making the application pursuant to a
 - Statutory function
 - A function discharged by virtue of Her Majesty's prerogative

(A) Individual applicant (fill in as applicable)

| | | | | | |
|------------------|-------------------------------------|---------------------------|----------------------------|---------------------------|---|
| Title: | <input checked="" type="radio"/> Mr | <input type="radio"/> Mrs | <input type="radio"/> Miss | <input type="radio"/> Ms | |
| Surname | KUCA | | | Forenames | JANUSZ ARTUR |
| Date of Birth | Day | Month | Year | I am 18 years old or over | Please tick |
| | | | | | <input checked="" type="checkbox"/> Yes |
| Nationality | POLISH | | | | |
| Home address | | | | | |
| | BLACKPOOL | | | | |
| | | | | Post Code | F Y 1 |
| Telephone Number | | | | Mobile Number | |
| E-Mail | | | | | |

31/5/17

Second individual applicant (if applicable)

| | | | | | |
|-------------------------|------------|------------------|-------------|----------------------------------|----------------------------|
| Title: | Mr | Mrs | Miss | Ms | |
| Surname | | | | Forenames | |
| Date of Birth | Day | Month | Year | I am 18 years old or over | <small>Please tick</small> |
| | | | | | Yes |
| Nationality | | | | | |
| Home address | | | | | |
| | | | | | |
| | | Post Code | | | |
| Telephone Number | | | | Mobile Number | |
| E-Mail | | | | | |

(B) OTHER APPLICANTS

Please provide name and registered address of the applicant in full. Where appropriate please give any registered number. In the case of a partnership or other joint venture (other than a body corporate), please give the name and address of each party concerned.

| | | | | | |
|---|--|------------------|--|--|--|
| Name | | | | | |
| Address | | | | | |
| | | | | | |
| | | Post Code | | | |
| Telephone Number | | | | | |
| E-Mail Address | | | | | |
| Registered number (where applicable) | | | | | |
| Description of applicant (e.g. partnership, company, unincorporated association) | | | | | |
| | | | | | |

Part 3 - Operating Schedule

When do you want the premises licence to start

| Day | | Month | | Year | | | |
|-----|---|-------|---|------|---|---|---|
| 2 | 4 | 0 | 6 | 2 | 0 | 1 | 7 |

If you wish the licence to be valid only for a limited period, when do you want it to end?

| Day | | Month | | Year | | | |
|-----|--|-------|--|------|--|--|--|
| | | | | | | | |

If 5000 or more people are expected to attend the premises at any one time, please state the number expected to attend

Please give a general description of the premises (Please see guidance note 1)

GENERAL GROCERY AND CONVENIENCE STORE.

What licensable activities do you intend to carry on from the premises?
 (Please see sections 1 and 14 and Schedules 1 and 2 to the Licensing Act 2003)

Provision of regulated entertainment (please read guidance note 2):

If yes please tick

- a) A performance of a play (if ticking yes, fill in box A)
- b) An exhibition of a film (if ticking yes, fill in box B)
- c) An indoor sporting event (if ticking yes, fill in box C)
- d) Boxing or wrestling entertainment (if ticking yes, fill in box D)
- e) A performance of live music (if ticking yes, fill in box E)
- f) Any playing of recorded music (if ticking yes, fill in box F)
- g) A performance of dance (if ticking yes, fill in box G)
- h) Entertainment of a similar description to that falling within (e), (f) or (g) (if ticking yes, fill in box H)

Provision of late night refreshment (if ticking yes, fill in box I)

Supply of alcohol (if ticking yes, fill in box J)

In all cases complete boxes K, L and M

A

| Performance of a play Standard timings (read guidance note 7) | | | Will the performance of a play take place indoors, outdoors or both? Please tick. (Read guidance note 3) | Indoors | |
|--|-------|--------|---|----------|--|
| Day | Start | Finish | | Outdoors | |
| | | | | Both | |
| Mon | | | <u>Please give further details here</u> (please read guidance note 4) | | |
| Tue | | | | | |
| Wed | | | <u>State any seasonal variations for performing plays</u> (please read guidance note 5) | | |
| Thurs | | | | | |
| Fri | | | <u>Non-standard timings. Where you intend to use the premises for the performance of a play at different times to those listed in the column on the left, please list</u> (please read guidance note 6) | | |
| Sat | | | | | |
| Sun | | | | | |

B

| Exhibition of film Standard timings (read guidance note 7) | | | Will the exhibition of films take place indoors, outdoors or both? Please tick. (Read guidance note 3) | Indoors | |
|---|-------|--------|---|---|------|
| Day | Start | Finish | | Outdoors | |
| Mon | | | | Please give further details here (please read guidance note 4) | Both |
| Tue | | | | | |
| Wed | | | State any seasonal variations for the exhibition of films (please read guidance note 5) | | |
| Thurs | | | | | |
| Fri | | | Non-standard timings. Where you intend to use the premises for the exhibitions of film at different times to those listed in the column on the left, please list (please read guidance note 6) | | |
| Sat | | | | | |
| Sun | | | | | |

C

| Indoor sporting events Standard timings (read guidance note 7) | | | Please give further details here (please read guidance note 4) |
|---|-------|--------|--|
| Day | Start | Finish | |
| Mon | | | State any seasonal variations for indoor sporting events (please read guidance note 5) |
| Tue | | | |
| Wed | | | |
| Thurs | | | Non-standard timings. Where you intend to use the premises for indoor sporting events at different times to those listed in the column on the left, please list (please read guidance note 6) |
| Fri | | | |
| Sat | | | |
| Sun | | | |

D

| Boxing or wrestling entertainment Standard timings (read guidance note 7) | | | Will the boxing or wrestling entertainment take place indoors, outdoors or both? Please tick. (Read guidance note 3) | Indoors | |
|---|-------|--------|---|----------|--|
| Day | Start | Finish | | Outdoors | |
| | | | | Both | |
| Mon | | | Please give further details here (please read guidance note 4) | | |
| | | | | | |
| Tue | | | | | |
| | | | | | |
| Wed | | | State any seasonal variations for boxing or wrestling entertainment (please read guidance note 5) | | |
| | | | | | |
| Thurs | | | | | |
| | | | | | |
| Fri | | | Non-standard timings. Where you intend to use the premises for boxing or wrestling entertainment at different times to those listed in the column on the left, please list (please read guidance note 6) | | |
| | | | | | |
| Sat | | | | | |
| | | | | | |
| Sun | | | | | |
| | | | | | |

E

| Performance of live music Standard timings (read guidance note 7) | | | Will the performance of live music take place indoors, outdoors or both? Please tick. (Read guidance note 3) | Indoors | |
|---|-------|--------|---|----------|--|
| Day | Start | Finish | | Outdoors | |
| | | | | Both | |
| Mon | | | Please give further details here (please read guidance note 4) | | |
| | | | | | |
| Tue | | | | | |
| | | | | | |
| Wed | | | State any seasonal variations for the performance of live music (please read guidance note 5) | | |
| | | | | | |
| Thurs | | | | | |
| | | | | | |
| Fri | | | Non-standard timings. Where you intend to use the premises for the performance of live music at different times from those listed in the column on the left, please list (please read guidance note 6) | | |
| | | | | | |
| Sat | | | | | |
| | | | | | |
| Sun | | | | | |
| | | | | | |

F

| Playing of recorded music Standard timings (read guidance note 7) | | | Will the playing of recorded music take place indoors, outdoors or both? Please tick. (Read guidance note 3) | Indoors | |
|---|-------|--------|---|----------|--|
| Day | Start | Finish | | Outdoors | |
| Mon | | | Please give further details here (please read guidance note 4) | Both | |
| Tue | | | | | |
| Wed | | | | | |
| Thurs | | | State any seasonal variations for playing recorded music (please read guidance note 5) | | |
| Fri | | | | | |
| Sat | | | Non-standard timings. Where you intend to use the premises for the playing of recorded music at different times to those listed in the column on the left, please list (please read guidance note 6) | | |
| Sun | | | | | |
| | | | | | |

G

| Performance of dance Standard timings (read guidance note 7) | | | Will the performance of dance take place indoors, outdoors or both? Please tick. (Read guidance note 3) | Indoors | |
|--|-------|--------|--|----------|--|
| Day | Start | Finish | | Outdoors | |
| Mon | | | Please give further details here (please read guidance note 4) | Both | |
| Tue | | | | | |
| Wed | | | | | |
| Thurs | | | State any seasonal variations for the performance of dance (please read guidance note 5) | | |
| Fri | | | | | |
| Sat | | | Non-standard timings. Where you intend to use the premises for the performance of dance at different times to those listed in the column on the left, please list (please read guidance note 6) | | |
| Sun | | | | | |
| | | | | | |

H

| | | | | | |
|--|--------------|---------------|--|----------|--|
| Entertainment of a similar description to that falling within (e), (f) or (g) Standard timings (read guidance note 7) | | | <u>Please give a description of the type of entertainment you will be providing</u> | | |
| Day | Start | Finish | Will this entertainment take place indoors, outdoors or both. Please tick. (Read guidance note 3) | Indoors | |
| Mon | | | | Outdoors | |
| | | | | Both | |
| Tue | | | <u>Please give further details here</u> (please read guidance note 4) | | |
| Wed | | | | | |
| Thu | | | <u>State any seasonal variations for entertainment</u> (please read guidance note 5) | | |
| Fri | | | | | |
| Sat | | | <u>Non-standard timings. Where you intend to use the premises for the entertainment at different times to those listed in the column on the left, please list</u> (please read guidance note 6) | | |
| Sun | | | | | |

I

| | | | | | |
|---|--------------|---------------|--|----------|--|
| Late Night Refreshment Standard timings (read guidance note 7) | | | Will the provision of late night refreshment take place indoors, outdoors or both? Please tick (Read guidance note 3). | Indoors | |
| Day | Start | Finish | | Outdoors | |
| | | | | Both | |
| Mon | | | <u>Please give further details here</u> (please read guidance note 4) | | |
| Tue | | | | | |
| Wed | | | | | |
| Thu | | | <u>State any seasonal variations for the provision of late night refreshment</u> (please read guidance note 5) | | |
| Fri | | | | | |
| Sat | | | <u>Non-standard timings. Where you intend to use the premises for the provision of late night refreshment at different times to those listed in the column on the left, please list</u> (please read guidance note 6) | | |
| Sun | | | | | |

J

| | | | | | |
|---|--------------|---------------|---|------------------|-------------------------------------|
| Supply of alcohol Standard timings (read guidance note 7) | | | Will the sale of alcohol be for consumption on the premises, off the premises or both? Please tick. (Read guidance note 8) | On the premises | |
| | | | | Off the premises | <input checked="" type="checkbox"/> |
| | | | | Both | |
| Day | Start | Finish | State any seasonal variations for the supply of alcohol (please read guidance note 5) | | |
| Mon | 08:00 | 20:00 | N/A | | |
| Tue | 08:00 | 20:00 | | | |
| Wed | 08:00 | 20:00 | | | |
| Thurs | 08:00 | 20:00 | | | |
| Fri | 08:00 | 20:00 | | | |
| Sat | 08:00 | 20:00 | | | |
| Sun | 08:00 | 20:00 | | | |
| | | | Non-standard timings. Where you intend to use the premises for the supply of alcohol at different times to those listed in the column on the left, please list (please read guidance note 6) | | |

K

Please highlight any adult entertainment or services, activities, other entertainment or matters ancillary to the use of the premises that may give rise to concern in respect of children (Please read guidance note 9)

NONE

L

| | | | | | |
|---|-------|--------|--|--|--|
| Hours premises are open to public Standard timings (read guidance note 7) | | | State any seasonal variations (please read guidance note 5) N/A | | |
| Day | Start | Finish | | | |
| Mon | 08:00 | 20:00 | | | |
| Tue | 08:00 | 20:00 | | | |
| Wed | 08:00 | 20:00 | | | |
| Thurs | 08:00 | 20:00 | Non-standard timings. Where you intend the premises to be open to the public at different times to those listed in the column on the left, please list (please read guidance note 6) N/A | | |
| Fri | 08:00 | 20:00 | | | |
| Sat | 08:00 | 20:00 | | | |
| Sun | 08:00 | 20:00 | | | |
| | | | | | |

M

State the name and details of the individual whom you wish to specify on the licence as the designated premises supervisor (Please see declaration about the entitlement to work in the checklist at the end of the form):

| | | | | | | |
|--|-------------------------------------|--------------------------|---------------------|--------------|------------|------|
| Surname | KUCA | | Forename(s) | JANUSZ ARTUR | | |
| State any previous names | N/A | | | | | |
| They are 18 years old or over | Yes | No | Their Date of Birth | Please tick | | |
| | <input checked="" type="checkbox"/> | <input type="checkbox"/> | | Day | Month | Year |
| Address | [Redacted] | | | | | |
| | BLACKPOOL | | | | | |
| | Post Code | F | 7 | 1 | [Redacted] | - |
| Telephone Number | [Redacted] | | | | | |
| Email Address | [Redacted] | | | | | |
| Personal Licence Number (if known) | PAS058 | | | | | |
| Issuing Licensing Authority (if known) | BLACKPOOL COUNCIL | | | | | |

31/5/17

Describe the steps you intend to take to promote the four licensing objectives:

a) General – all four licensing objectives (b,c,d,e) (See guidance note 10)

- PROPER TRAINING OF SHOP STAFF
- EFFECTIVE SECURITY
- RISK ASSESSMENTS

b) The prevention of crime and disorder

- ALARMED PREMISES
- CCTV AT AND AROUND PREMISES. CCTV CAN BE VIEWED REMOTELY AT ANY TIME
- EXTERNAL LIGHTING
- POSITIONING ALCOHOL AWAY FROM SHOP ENTRANCE TO PREVENT 'GRAB AND RUN'

c) Public Safety

- CCTV
- FIRE DETECTION AND FIGHTING EQUIPMENT ON THE PREMISES
- REFUSAL TO SERVE ALCOHOL TO CUSTOMERS WHO ARE DRUNK OR AGGRESSIVE.

d) The prevention of public nuisance

- TAKE STEPS TO DISPERSE ANY GROUPS OF PEOPLE WHO MAY CONGREGATE OUTSIDE THE SHOP
- PREVENTION OF EXCESSIVE NOISE FROM CUSTOMERS
- COLLECTION OF RUBBISH / LITTER WHICH MAY ACCUMULATE OUTSIDE THE SHOP

e) The protection of children from harm

- A STRICT NO ID - NO SALE / CHALLENGE 25 SYSTEM. ANYBODY WHO APPEARS TO BE UNDER 25 MUST SHOW ID BEFORE SERVICE. ACCEPT ONLY DRIVING LICENCE OR PASSPORT OR 'PASS' OR EU IDENTITY CARD.
- MAINTAIN A 'REFUSAL BOOK' AS NECESSARY.

Checklist

Please tick

- I have made or enclosed payment of the fee
- I have enclosed the plan of the premises
- I have sent copies of this application, including the plan and form of consent by the proposed DPS (if applicable), to the responsible authorities
- I have enclosed the consent form completed by the individual I wish to be the Designated Premises Supervisor, if applicable
- I understand that I must now advertise my application. *(You may be asked to prove this, it is therefore in your best interests to provide a copy of the advert to the Licensing Department).*
- I understand that if I do not comply with the above requirements my application will be rejected
- (Applicable to all individual applicants, including those in a partnership which is not a limited liability partnership, but not companies or limited liability partnerships):
I have included documents demonstrating my entitlement to work in the United Kingdom (please read note 15)

IT IS AN OFFENCE, UNDER SECTION 158 OF THE LICENSING ACT 2003, TO MAKE A FALSE STATEMENT IN OR IN CONNECTION WITH THIS APPLICATION, THOSE WHO MAKE A FALSE STATEMENT MAY BE LIABLE ON SUMMARY CONVICTION TO A FINE OF ANY AMOUNT.

IT IS AN OFFENCE UNDER SECTION 24B OF THE IMMIGRATION ACT 1971 FOR A PERSON TO WORK WHEN THEY KNOW, OR HAVE REASONABLE CAUSE TO BELIEVE, THAT THEY ARE DISQUALIFIED FROM DOING SO BY REASON OF THEIR IMMIGRATION STATUS. THOSE WHO EMPLOY AN ADULT WITHOUT LEAVE OR WHO IS SUBJECT TO CONDITIONS AS TO EMPLOYMENT WILL BE LIABLE TO A CIVIL PENALTY UNDER SECTION 15 OF THE IMMIGRATION, ASYLUM AND NATIONALITY ACT 2006 AND PERSUANT TO SECTION 21 OF THE SAME ACT, WILL BE COMMITTING AN OFFENCE WHERE THEY DO SO IN THE KNOWLEDGE, OR WITH REASONABLE CAUSE TO BELIEVE, THAT THE EMPLOYEE IS DISQUALIFIED.

Part 4 – Signatures (please read guidance note 11)

Declaration

- (Applicable to individual applicants only, including those in a partnership which is not a limited liability partnership):
I understand I am not entitled to be issued with a licence if I do not have the entitlement to live and work in the UK (or if I am subject to a condition preventing me from doing work relating to the carrying on of a licensable activity) and that my licence will become invalid if I cease to be entitled to live and work in the UK (please read guidance note 15).
- The DPS named in this application form (if applicable) is entitled to work in the UK (and is not subject to conditions preventing him or her from doing work relating to a licensable activity) and I have seen a copy of his or her proof of entitlement to work (please see note 15).

Signature of applicant or applicant's solicitor or other duly authorised agent (please read guidance note 12). **If signing on behalf of the applicant please state in what capacity.**

| | |
|------------|---|
| Signature |  |
| Print Name | JANUSZ ARTUR KUCA |
| Capacity | APPLICANT |
| Date | 24 th May 2017 |

For joint applications, signature of 2nd applicant or 2nd applicant's solicitor or other authorised agent. (Please read guidance note 13) **If signing on behalf of the applicant please state in what capacity.**

| | |
|------------|--|
| Signature | |
| Print Name | |
| Capacity | |
| Date | |

Contact name (where not previously given) and address for correspondence associated with this application. (Please read guidance note 13)

| | | | | | | | |
|--|-------------------------|-----|------|----|----------------------|------------------|--|
| Title: | Mr | Mrs | Miss | Ms | | | |
| Forename(s) | | | | | Surname | | |
| Address for Correspondence associated with this application | | | | | | | |
| | | | | | | Post Code | |
| | Telephone Number | | | | Mobile Number | | |
| E-Mail Address | | | | | | | |

Revision --
 DRAWING No. AO17/134/U01

Page 22

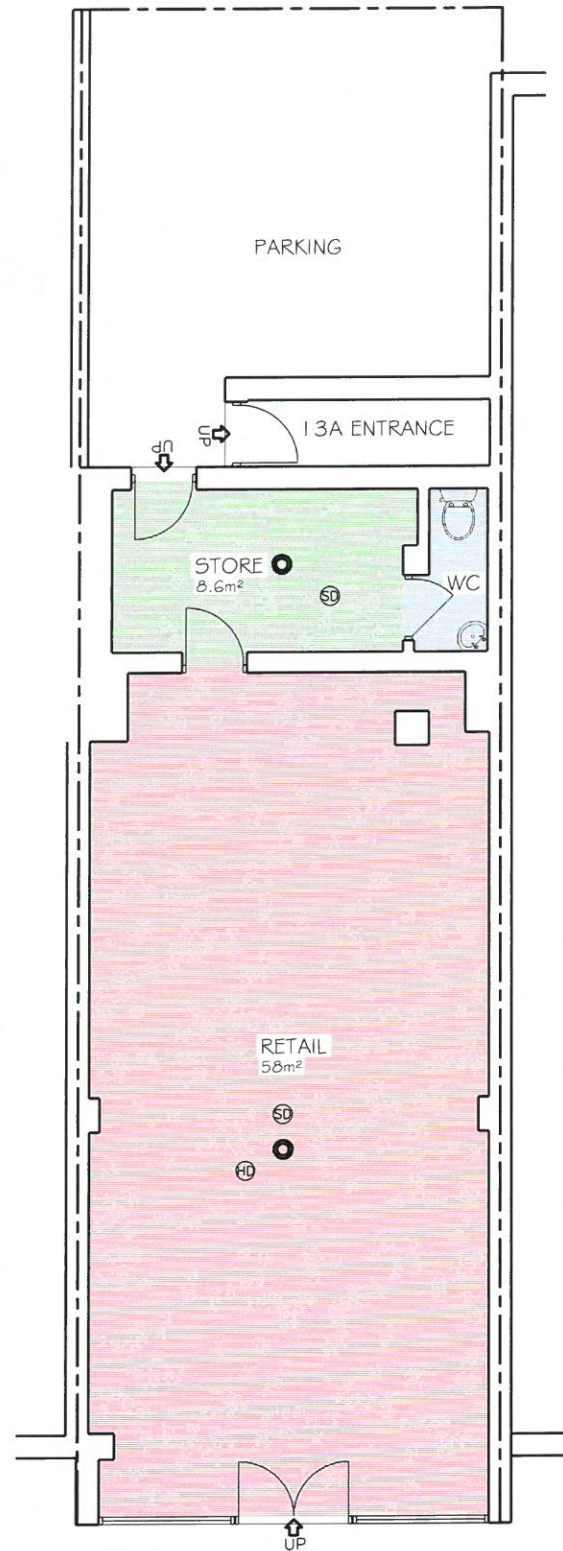

GROUND FLOOR PLAN SCALE 1:100

| CONFIGURATION |
|---------------------------------------|
| INTERNAL FLOOR AREA 112m ² |
| TOTAL PLOT AREA 112m ² |

LAYOUT TO BE APPROVED BY BUILDING CONTROL & LOCAL FIRE OFFICER.

KEY TO SYMBOLS

- DETECTORS
- DRY AREA
- BEER / BOTTLE STORE
- SERVICE / WET AREA
- W/C

Keystone Design Associates Ltd.
 261 Church Street
 Blackpool
 FY1 3PB
 Tel. No. 01253 649040
 Fax. No. 01253 752901
 Email : Info@keystonedesign.co.uk

PROJECT ADDRESS
 13 WESTCLIFFE DRIVE
 BLACKPOOL

PROJECT TITLE
 LICENSING PLAN

CLIENT
 MR JANUSZ KUCA

DRAWING TITLE
 LICENSING PLAN

Drawn LM Chkd Date 25/05/2017

DRAWING No. AO17/134/U01 Scales 1:100@A3 Revision

F:\Server\Documents\Drawings\2017\Westcliffe Drive 13

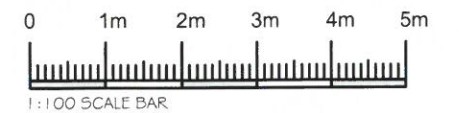

THIS DRAWING & CONTENTS ARE THE PROPERTY OF KEYSTONE DESIGN ASSOC LTD. UNAUTHORISED REPRODUCTION OF THE WHOLE OR ANY PART THERE OF INFRINGES COPYRIGHT AND MAY LEAD TO PROSECUTION OF CIVIL PROCEEDINGS.

| | | | |
|------|------------|------|----|
| -- | -- | -- | -- |
| Rev. | Amendments | Date | By |

Received

13 JUN 2017

Appendix 4b

8/06/2017

TO

Licensing Service, Blackpool Council, Municipal Buildings, PO Box 4,
Blackpool, FY1 1NA

FROM

Tracy Andrea Harries



Sub: premises licence Open application 070468 Mr Janusz Artur Kuca

To whom it may concern,

I am a resident of Layton and I am shocked to see another premises licence application for Folklore 13 Westcliffe Drive, Blackpool, Lancashire, FY3 7BJ, DPS and Applicant Mr Janusz Artur Kuca.

In the space of 300 yards we have a Tesco express, PG Discount store, Mc colls, Best one, CO-OP few hundred yards we have a Esso garage & Layton wines how many more do we need? Present premises 13 Westcliff drive share the same wall to another off licence 11 Westcliffe drive T/A Westcliffe food and wine Best one.

Crime and disorder, public safety

I have noticed at weekend's young groups hanging around the bus stops and off-licences in Layton throwing litter outside and creating nuisance for the public, Vandalising the bus stops, Bins thrown on to the road all caused by excess alcohol. I have also noticed so many drinking around Layton cemetery and public sex and I don't even feel safe walking my dog around layton.

Prevention of children from harm

There is 2 schools near by and I have seen many kids walk through Layton attending Layton primary and St Mary's it would encourage group to congregate and I don't think its an good example.

I would also like to remind Blackpool has high levels of alcohol related harm (health, disorder, violence) for the size of the population.

The health of people in Blackpool is generally worse than the England average and there are marked inequalities both between Blackpool and the national average and within the town itself. Life expectancy for men in Blackpool is the lowest in the country at 73.6 years and third lowest in the country for females at 79.4 years (England averages of 78.6 for men and 82.6 for women). There is considerable variation within Blackpool where life expectancy is

12.8 years lower for men and 8.1 years lower for women in the most deprived areas than the least deprived areas of the town. Although the overall trend shows life expectancy to be improving, it is not improving as fast in Blackpool as it is elsewhere and the gap between Blackpool and the national average is widening. Not only do people in Blackpool live shorter lives, but they also spend a smaller proportion of their lifespan in good health and without disability and in the most deprived areas of the town disability-free life expectancy is around 50 years. One of the main causes of shorter life expectancy in Blackpool is alcohol related diseases.

Based on these grounds I strongly object Mr Janusz Artur Kuca premises licence application for Folklore 13 Westcliffe Drive, Black pool, Lancashire, FY3 7BJ,

Yours sincerely
Tracy Andrea Harries

A handwritten signature in black ink, appearing to read 'T. Harries', written in a cursive style.

06/06/2017

From

Ms Deborah Creighton

[Redacted]

TO,

Licensing service Blackpool,

Municipal Building, PO Box 4, Blackpool FY11NA

Received

13 JUN 2017

To whom it may concern,

I'm writing to register my objection to the application for a premises license by Mr Janusz Artur Kuca for Folklore 13 Westcliff drive Blackpool Fy3 7Bj

The basis of this opposition is that granting a license for these premises will not promote the licensing objectives particularly the prevention of crime disorder and anti social behaviour

Residents in this area already suffer anti social behaviour noise nuisance at all hours day and night and have suffered this for a long time.

For Layton residence it is populated by off-licence outlets and I don't think we need another one.

In view of the above I would urge the licensing authority to refuse this application



Yours sincerely

Ms Deborah Creighton

This page is intentionally left blank

Sharon Davies

From: Andrew Airey [redacted]
Sent: 15 June 2017 13:35
To: Licensing la2003
Subject: Objection to an application for a alcohol premise licence at 13 Westcliffe Drive, Blackpool

Dear Sirs

I have an office at 23a Westcliffe Drive and wish to object to the application by Mr Janusz Artur Kuca for an alcohol premises licence at 13 Westcliffe Drive.

Firstly there are already numerous outlets in the Layton area selling alcohol, including one next door to the applicant. Infact, I would say that the area is already saturated with licensed premise and amongst the many facilities we require here, another shop selling alcohol is not one of them.

Our front door is slightly recessed and it already attracts unsavoury elements who gather at night, light up cigarettes, drink alcohol, leave litter and occasionally use it as a urinal. An additional licensed outlet is only likely to make this situation worse.

The incidence of unruly and abusive behaviour seems to be on the rise in Layton, it may only be a perception but the area is certainly not the pleasant and peaceful place it was some years ago. It would seem to me that an additional store selling alcohol, will only lead to more public nuisance.

Layton is an area frequented by many school children and I would respectfully advise the Licensing Committee to give this much thought when considering the application.

Yours faithfully

Andrew S Airey

[redacted]

<http://www.blackpool.gov.uk/EmailDisclaimer/> This message has been scanned for inappropriate or malicious content as part of the Council's e-mail and Internet policies.

This page is intentionally left blank

Received

16 JUN 2017

03/06/2017

TO

Licensing Service, Blackpool council

Municipal buildings, PO Box 4

Blackpool FY11NA

I object to the licence applied by Mr Janusz Artur Kuca for the property Folklore 13 Westcliffe Drive, Blackpool, FY3 7BJ on the basis as follows

Opposite this shop there is Layton cemetery and there is lot of young people gather in group and cause nuisance and anti-social behavior.

The area immediately around this location is one that suffers from disorder and anti-social behavior, with much of that behavior fueled by alcohol.

There are many problematic youths around the area these youths often gather outside similar shops causing problems and badgering people in an attempt to get alcohol.

I also don't think it would help with the street drinking and begging around the area.

Our police force can do without any more problem regarding theft and antisocial behavior by another off license.

We also have 7 licensed premises national and local retailers in Layton. It's more than what the residents need.

I have also noticed the premises license application is not visible 24 hours a day as the notice is not visible when the shutters come down 7pm to 8 am.

Yours sincerely

Joanne Rodgers



This page is intentionally left blank

**WESTCLIFFE FOOD AND WINE
BEST-ONE
11, Westcliffe Drive
BLACKPOOL
FY37BJ
TEL 01253 393473**

MR. J.R. WIDOP



**RECENTLY WE BECAME AWARE FOLKLORE CONTINENTAL FOODS 13 WESTCLIFFE DRIVE APPLIED FOR AN OFF LICENCE . WE DO NOT THINK THIS IS NECESSARY AS THE LOCAL AREA IS WELL CATERED FOR AND FURTHERMORE WILL GO AGAINST BLACKPOOL COUNCIL'S LICENCE OBJECTIVES EG. INCREASE THE LIKELYHOOD OF CRIME AND DISORDER, PUBLIC SAFETY,PUBLIC NUISANCE AND PROTECTION OF CHILDREN BY THE INCREASED AVAILABILITY OF ALCOHOL, INCREASED DELIVERY VEHICLES,INCREASED ANTI SOCIAL BEHAVIOUR AND AS THEIR ARE LOCAL SCHOOLS CHILDREN WILL BECOME MORE EXPOSED TO ALCOHOL.
IF YOU AGREE PLEASE SIGN BELOW-**

| NAME | ADDRESS | SIGNATURE |
|--------------------|-----------------------|--------------------|
| Kyle Jackson | 13 Westcliff Drive | K. J. |
| Jane Weatherill | 22 Norwood Ave | J. Weatherill |
| Jackie Parkinson | 27 Norwood Ave | J. Parkinson |
| Steven Craughton | 16, Lincoln Road | Steven Craughton |
| Soanne Rodgers | 31 Scotton Ave Layton | S. Rodgers |
| MICHAEL RODGERS | 28 MEYER AV | M. Rodgers |
| MICHAEL WILLIAMS | 9 Grenfell | M. Williams |
| DAMIEN LAMBERT | 69 DINMORE AVE | D. Lambert |
| NILU MALIKU | 31 ENFIELD RD. | N. Maliku |
| Tracy Wood | 17 Wealby Street | T. Wood |
| SHIRLEY SPECK | 4 GARDEN RD | S. Speck |
| Ryan Simand | 16 Grenfell Ave | R. Simand |
| S. Stowell | 42 Chouilly Ave | S. Stowell |
| A. [unclear] | 21 Broughton AV | A. [unclear] |
| A. [unclear] | 43 Chipping Grove | A. [unclear] |
| K. O'CONNOR | 21 Ching Lay | K. O'Connor |
| LISA PECK | 68 Broughton | L. Peck |
| ANNIE HIRST | 16 MATHER ST | A. Hirst |
| ANDY TAYLOR | 215 D'AMORE | A. Taylor |
| S. [unclear] | 7 Dreyeast | S. [unclear] |
| Doreen Appala | 25 Grenfell Avenue | D. Appala |
| RUTH PLANT | 20 WARWICK RI | R. Plant |
| Jonathan [unclear] | 8 Broughton AVE | J. [unclear] |
| Samantha Trotter | 14 Wilford St | S. Trotter |
| Christina Corley | 8 Broughton Ave | C. Corley |
| JAMES BENNETT | 38 LYNWOOD AVENUE | J. Bennett |
| Anne Williamson | 2 Gageside Court | A. Williamson |
| Euron McCabe | 21 BROUGHTON AV | E. McCabe |
| Sue CHARLES | 15 WILLIAM ST | S. Charles |
| ISABEL Dawne | 9th Westcliffe Drive | I. Dawne |
| Heather Bonnick | 69 Onslow Rd | H. Bonnick |
| Emma Hand | 4 Jackson Street | E. Hand |
| DUNCAN HARGREAVE | 18 Jackson Street | D. Hargreave |
| Robert Cruickshank | 10 Dinmore Ave | R. Cruickshank |
| ANTHONY LESS | 14 NORWOOD AVE | A. Less |
| Nicky Bennett | 4 LYNWOOD AVE | N. Bennett |
| Steve Williams | 89 NORMAN AVE | S. Williams |
| ANDY JONES | 14 SHENSHE | A. Jones |
| JLEST | 53 SCOTTON AVE | J. [unclear] |
| DAVE WATWELL | 22 WESTCLIFFE | D. Watwell |
| DAVID HIND | 61 CIREFELL AVE | D. Hind |
| GUSAN HIND | " " " | G. Hind |
| S. H. W. [unclear] | 22 CHINWORTH AV | S. H. W. [unclear] |
| Self w. [unclear] | 13 Northumberland Ave | Self w. [unclear] |
| SPIROS SELLOS | 15 Westcliffe Drive | S. Sellos |
| MUS A SELLA | Flat 17 Westcliffe Dr | M. Sella |
| Jordan Robinson | 21 Grenfell Ave | J. Robinson |
| Brian [unclear] | 56 ARCADE AVE | B. [unclear] |

This page is intentionally left blank